

Edifier

www.edifier.com

EDIFIER ENTERPRISES CANADA INC.

Made in China

One Year Limited Warranty

Edifier warrants to the end user that all of its computer speaker systems are free from defects in materials and workmanship in the course of normal and reasonable use for a term of one year from the date of purchase. This warranty is the exclusive and only warranty in effect relative to Edifier multimedia speaker systems and any other warranties, either expressed or implied, are invalid. Neither Edifier nor any authorized Edifier reseller is responsible for any incidental or consequential damages incurred in the use of the speakers. (This limitation of incidental or consequential damage is not applicable where prohibited.)

Edifier's obligation under this warranty does not apply to any defect, malfunction or failure as a result of misuse, abuse, improper installation, use with faulty or improper equipment, or the use of the speaker systems with any equipment for which they were not intended.

The terms of this warranty apply only to speaker systems when such speakers are returned to the respective authorized Edifier reseller where they were purchased.

Under the terms of this warranty, the original consumer purchaser has certain legal rights and may have other rights, which vary worldwide.

Notice:

Edifier and Edifier logo are owned by Edifier Enterprises Canada Inc. and may be registered. Other Brand names and trademarks are the property of their owners. Edifier assumes no responsibility for any errors that may appear in this manual. Information contained herein is subject to change without notice.

To allow for design and specification improvements, the information in this document is subject to change without prior notice.

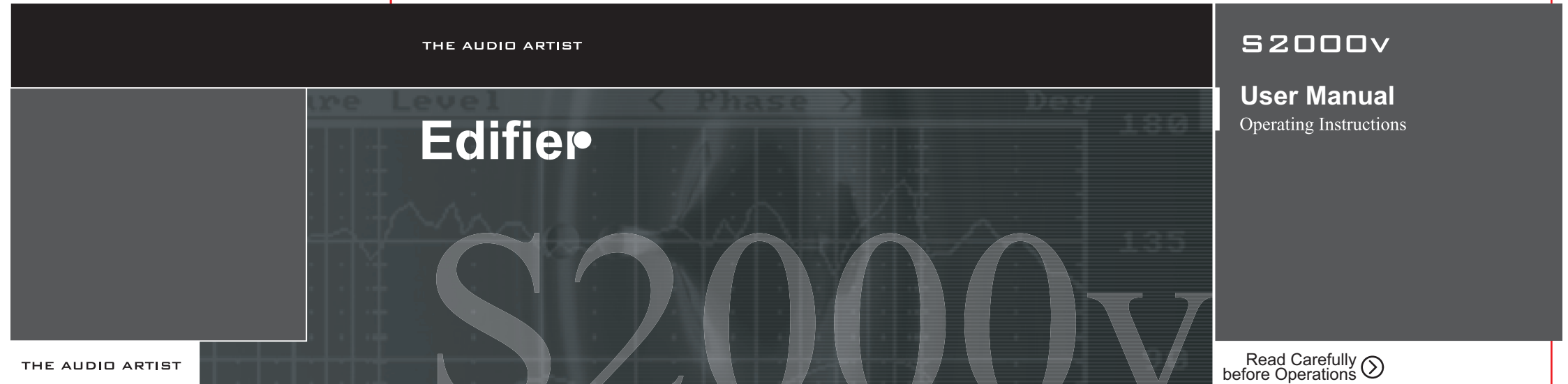

- Please read all the instructions herein.
 - Please retain this manual safely for future reference.
 - Please heed all safety warnings.
 - Please Install in accordance with the Manufacturer's instructions.
 - Please adjust the volume control to a comfortable level to avoid damaging your hearing and the system.
- WARNING**
- Do not use the speakers near water, and do not immerse them in any liquid or pour any liquid on them.
 - Do not block the openings in the speaker cabinets, never push objects into speaker vents or slots because of fire or electric shock hazards, and provide sufficient space around the speakers for proper ventilation.
 - Do not install near any heat sources such as radiators, heat registers, stoves, or other apparatus (including amplifiers) that produce heat.
 - Do not defeat the safety purpose of the polarized plug. A polarized plug has two blades with one wider than the other. The wider blade is provided for your safety. If the provided plug does not fit into your outlet, consult an electrician for replacement of the obsolete outlet. Protect the power cord from being walked on or pinched particularly at plugs, convenience receptacles, and the point where they exit from the apparatus.
 - For added protection during lightning storms, unplug the speakers from the electrical outlet and turn off the computer.
 - Unplug this apparatus when unused for long periods of time.
 - Heat---- Place the speakers away from all heat sources, such as heat registers, stoves, and direct sunlight.
 - Ventilation ---- Do not block the openings in the speaker cabinets, never push objects into speaker vents or slots because of fire or electric shock hazards, and provide sufficient space around the speakers for proper ventilation.
 - Location ---- Place the speakers in a stable location so that it will not fall causing damage to the speakers or bodily harm.
 - Cleaning --- Unplug the speakers from the computer and from the electrical outlet before cleaning them with a damp cloth.
 - Lightning ----For added protection during lightning storms, unplug the speakers from the electrical outlet and turn off the computer. Servicing is required when the apparatus has been damaged in any way, such as the power-supply cord or plug is damaged, liquid has been spilled or objects have fallen into the apparatus, the apparatus has been exposed to rain or moisture, does not operate normally, or has been dropped. Refer all servicing to qualified service personnel only.

WARNING:
TO REDUCE THE RISK OF ELECTRIC SHOCK, DO NOT EXPOSE THIS APPARATUS TO RAIN OR MOISTURE.



This indicates the appliance is a Class 2 Power Unit



For Indoor Use Only



The lightning flash with arrowhead, within an equilateral triangle, is intended to alert the user to the presence of un-insulated dangerous voltage within the product's enclosure that may be of a sufficient magnitude to constitute a risk of electric shock to persons.



The exclamation point within an equilateral triangle is intended to alert the user to the presence of important operating and maintenance (servicing) instructions in the literature accompanying the product.



CAUTION: TO PREVENT THE RISK OF ELECTRIC SHOCK, DO NOT REMOVE COVER (OR BACK). NO USER-SERVICEABLE PARTS INSIDE. REFER SERVICING TO QUALIFIED SERVICE PERSONNEL ONLY.

Noise, Hiss, Buzz, etc.

The signal to noise ratio from the S2000V in itself is extremely low. Some sources might produce noises that are higher in nature, e.g. a poor quality Soundcard. Please ensure to unplug the source when testing it.

Please use the rear mounted power switch to avoid “switch-on thump” when powering on and off the S2000V. To avoid voltage spikes and surges, please do not remove the AC power cable when amplifier is still in the switched ON position.

About the magnetically shielded drivers

The Edifier S2000V is equipped with magnetically shielded drivers to keep magnetic interference to nearby CRT monitors and TVs to an absolute minimum.

In the unlikely event any color fringing or picture distortion is noticed, please move the speakers a little further away.

Only one speaker has sound

Please ensure system is switched to OFF and check all connections carefully. Ensure the balance control (if used) on the soundsource is set to the center position.

No sound or weak sound

If you cannot hear sound from your speakers, it may mean the speakers are not connected properly, the amplifier is set to “Mute”, the soundsource is not setup correctly, or the speaker amplifier could be defective. You can test the soundsource by connecting headphones to it. If headphones work, you know the soundsource is set up and working correctly. Try connecting the speakers to a portable sound device such as a Walkman, AM/FM radio, or portable CD player. Try plugging the speaker system into the Headphone jack, but please make sure you lower the volume so you do not overpower the speakers.

If they do work on an alternate source, check the system Volume Control of the soundsource in question, and that it is not Muted.

If the speakers still do not work through the headphone jack method, they may require servicing from a qualified technician. Please contact your retailer for details.

Trouble Shooting Guide:

Amplifier output power: 2 channels, RMS 40Wx2(fo=1kHz, THD=10%)
Amplifier short time continuing output power: 2 channels, RMS 48Wx2(fo=1kHz, THD=10%).
Amplifier distortion: THD+N<0.05%(20W output per channel)
Amplifier signal to noise ratio: >=90db
Amplifier frequency response: 20Hz-20KHz
Input: RCA
Input impedance: 50K Ohm
Bass driver: 5.5 inch, HSCC composite paper cone (148mm), Magnetically Shielded, 6 Ohm.
Tweeter: 1 inch, silk dome, Magnetically shielded, 6 Ohm
Control: Knob and line control for Volume, Super Bass, Treble, Volume and Standby.
Power input: 100V-120V ~, 50/60Hz (for Model USA/Canada/Japan)
220V-240V ~, 50/60Hz (for Model European/China/Korea /South America, etc.)
Max Power Consumption: 120W
Speaker dimension: 176(W)x331(H)x319(D) mm
Weight: approx. 17.2 kg

Specifications:

Congratulations on the purchase of the Edifier S2000V speaker system. With the right care and attention, it will give you years of trouble free operation.

Before operating the system, please read this manual fully to obtain the best from your results from your new product, and retain it carefully for future reference.

Catalog

- 1、 Packing list
- 2、 Overview
- 3、 Description of the back panel
- 4、 Description of the line control
- 5、 Connecting and placement
- 6、 Speaker breaking-in
- 7、 Specifications
- 8、 Trouble shooting

The packing materials are carefully selected to be of a very high quality to ensure that the speakers are not damaged during the transportation. Please fill in the warranty card when purchasing the product and make sure the warranty card is sealed by the retailer. Please keep the card in a safe place in case it is needed for warranty purposes.

Please check the speaker model number marked on the packing carton. Please contact the seller as soon as possible if you find the speaker is the incorrect model or has sustained shipping damage. There are two packages for this product, please be careful of the high gloss piano finish during unpacking.

Packing List

Packaged Item List:

- Active speaker: 1
- None-active speaker: 1
- Signal cable for connection of the two speakers in length of 2.5 M: 1
- User Manual: 1
- 3.5 mm Headphone Plug /2 P Audio cable: 1
- Line control: 1
- Rubber feet for underside protection: 1 set

Speaker Break-in:

As with all high quality loudspeakers, the sonic performance will change subtly during the initial listening period. If the speaker has been stored in a cold environment, the damping compounds and suspension materials of the drive units will take some time to recover their correct mechanical properties. The drive unit suspensions will also loosen up during the first 10-15 hours of use. The time taken for the speaker to achieve its intended performance will vary depending on the previous storage conditions and how it is to be used. As a general rule, please allow up to a week for the temperature effects to stabilize, and 20 hours of average music use for the mechanical parts of the drivers to attain their intended design properties. The subtle result of this break-in will be a slightly warmer and more open sound in general.

Other Service Information:

Avoid exposing the surfaces of the speakers or speaker drivers to contact with corrosive liquids or gas. Do not place the speaker system into high temperature, high moisture places, or where the temperature or moisture fluctuates considerably. Avoid placement in direct sunlight for long periods of time. Please dust only with a clean soft cloth. The use of any chemical cleaners or abrasives is not recommended. For more stubborn stains a slightly damp soft cloth with a mild dish soap solution may be used after switching the system Off and removing the AC plug. DO NOT use lacquer thinner, alcohol, benzene, thinners, gasoline, or any abrasive cleaner, as the finish will be damaged. The Edifier Warranty does not cover such damage to the finish of the speakers. DO NOT use excessive water on the cleaning cloth due to electrical safety. The front grille covers can prevent dust buildup forming on the drivers. As this might affect sound quality slightly, it is better to keep speakers protected with the grilles left on.

Speaker Break-in:

How to place the speakers:

This product is designed to be used on bookshelves or desktops. Please leave at least 1.5 meters between the two speakers. For best results, keep a 1 meter distance or more away from the speakers when listening.

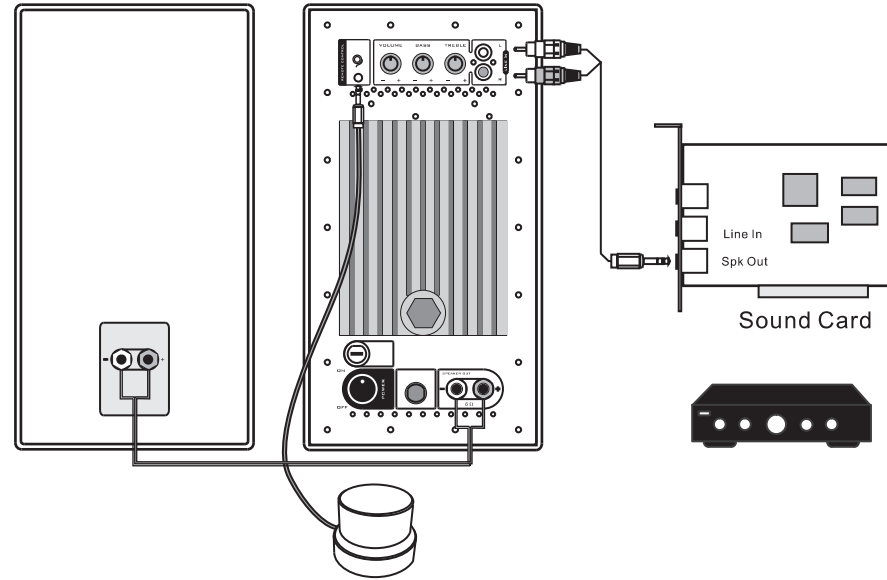

How to place and connect speakers:

Connecting to a sound source:

Connect the line controller cable plug into the dedicated socket, and then connect the audio cable with the RCA plugs into the RCA input sockets on the rear of the active speaker. The 3.5mm jack plug may be plugged into a soundcard, Discman, or game console etc. Various combinations of adapters will allow different source hookups for special purposes. Adjust the Volume control (or line controller if connected) to a comfortable listening level. When the line control is plugged in, the volume control knob on the back panel of the active speaker is deactivated.

How to connect the speakers:

Connect one end of the speaker cable to the line out sockets on the back of the active speaker, and the other end to the line-in sockets on the back of the non-active speaker. To ensure correct phase, be sure to match red to red and black to black terminal connectors. Please see the illustration figure for details. Do not shorten the speaker cables. Make sure the connections are tight and that there are no short circuits across the terminals. The quality of the speaker cables might affect the overall sound quality, which the speakers produce. The use of Oxygen-free copper (OFC) cables or other high quality cables as an option, are highly recommended.

Connecting to the power:

After correctly connecting the speakers and audio source, plug in the power supply. Please make sure the local electricity voltage is correct for this product. Please keep the power switch on the rear of the active speaker switched to OFF when plugging into the power outlet.

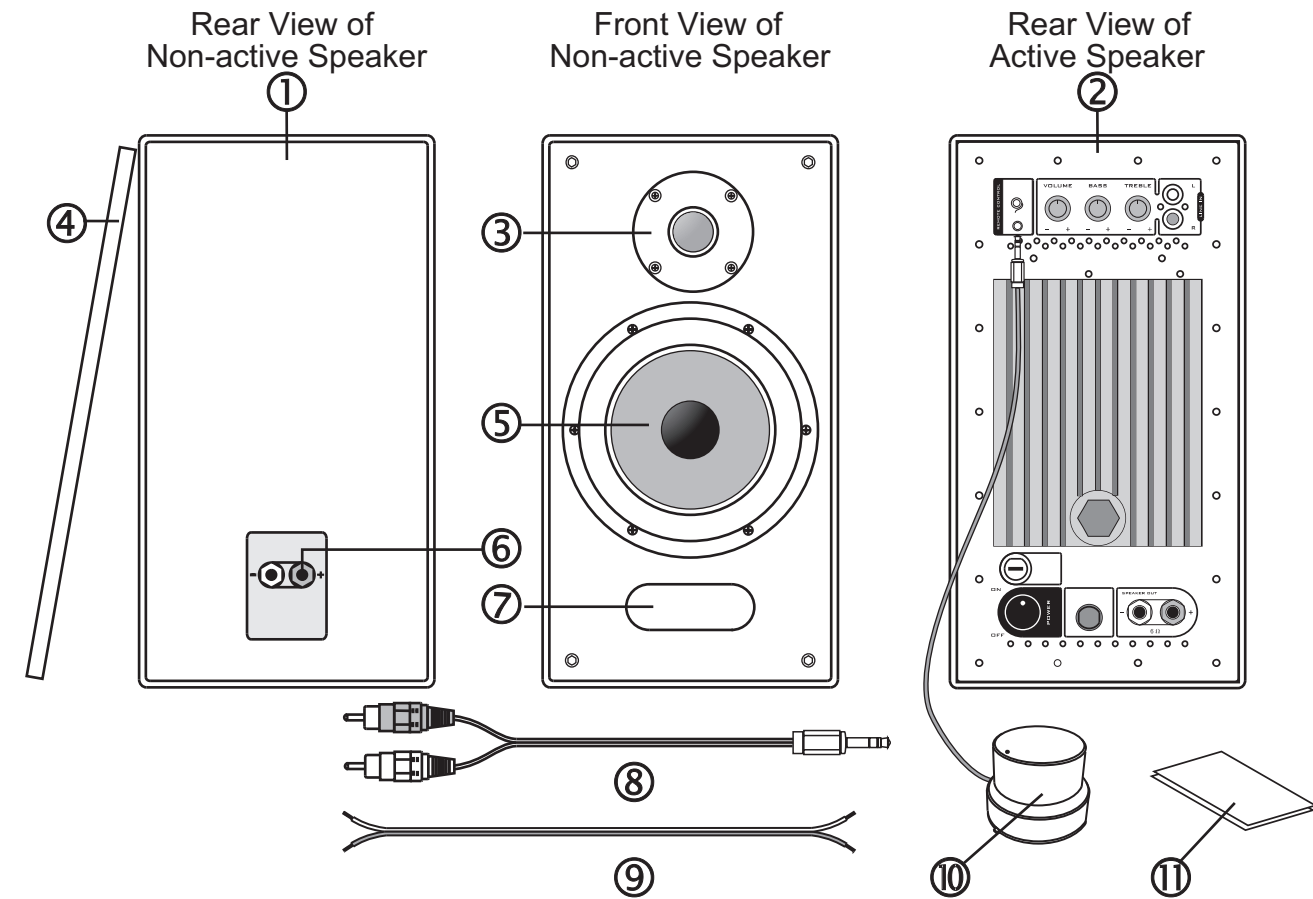
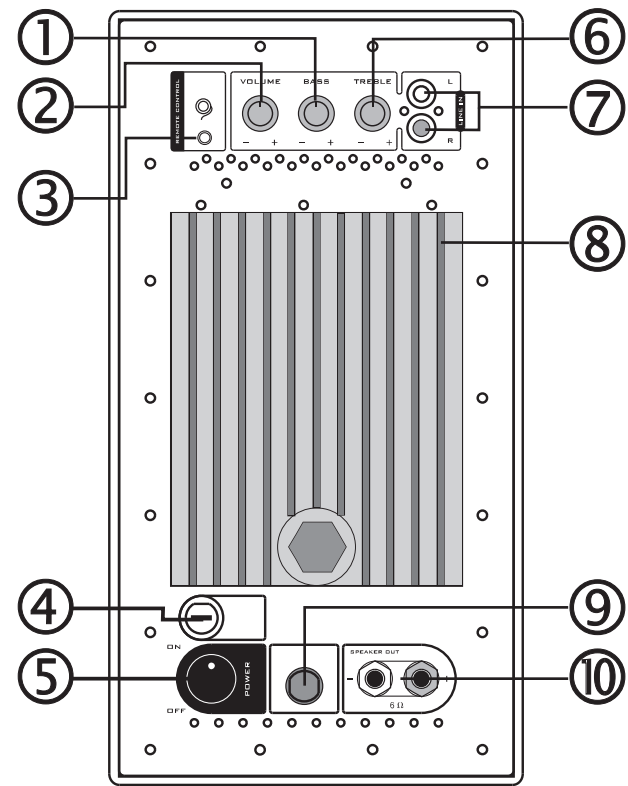

Diagram Nomenclature List:

- | | |
|-------------------------|--|
| 1、 Non-active speaker | 7、 Bass port |
| 2、 Active speaker | 8、 3.5 mm Headphone Plug /RCA Plug Audio cable |
| 3、 Tweeter | 9、 Speaker cable |
| 4、 Front cover | 10、 Line controller |
| 5、 Bass driver | 11、 User manual and warranty card |
| 6、 Speaker input socket | |



Description of the back panel

- | | |
|-----------------------------|-------------------------------------|
| 1、 Bass volume control knob | 6、 Treble volume control knob |
| 2、 Main volume control knob | 7、 Line-in port |
| 3、 Line control plug-in | 8、 Heat sink |
| 4、 Fuse | 9、 Power cord |
| 5、 Power switch | 10、 Connector to non-active speaker |

Part list:

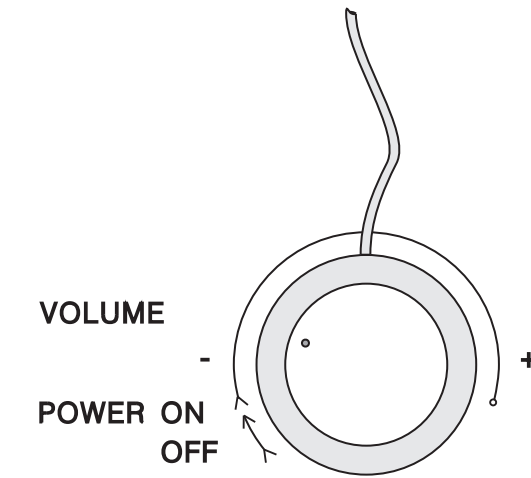
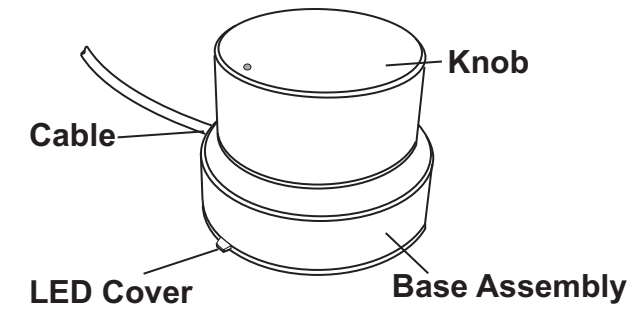

Description of the line controller

In addition to using the volume control on the back panel, there is a specially designed line level control for the S2000V to control power and volume.

Notice for usage of line control:

- 1、 Do not place the control near to anything with electricity to avoid electric shock.
- 2、 Avoid unnecessary force when turning the controller knob, or damage may occur.
- 3、 Do not plug in or unplug frequently when in use to avoid any damage to the circuits.
- 4、 It is normal for the control knob on the back panel to rotate when you turn the line control.
- 5、 When the line control is plugged in, the volume control knob on the back panel is deactivated.
- 6、 The line control is specially designed for this speaker; do not use it with any other Edifier models or products.